

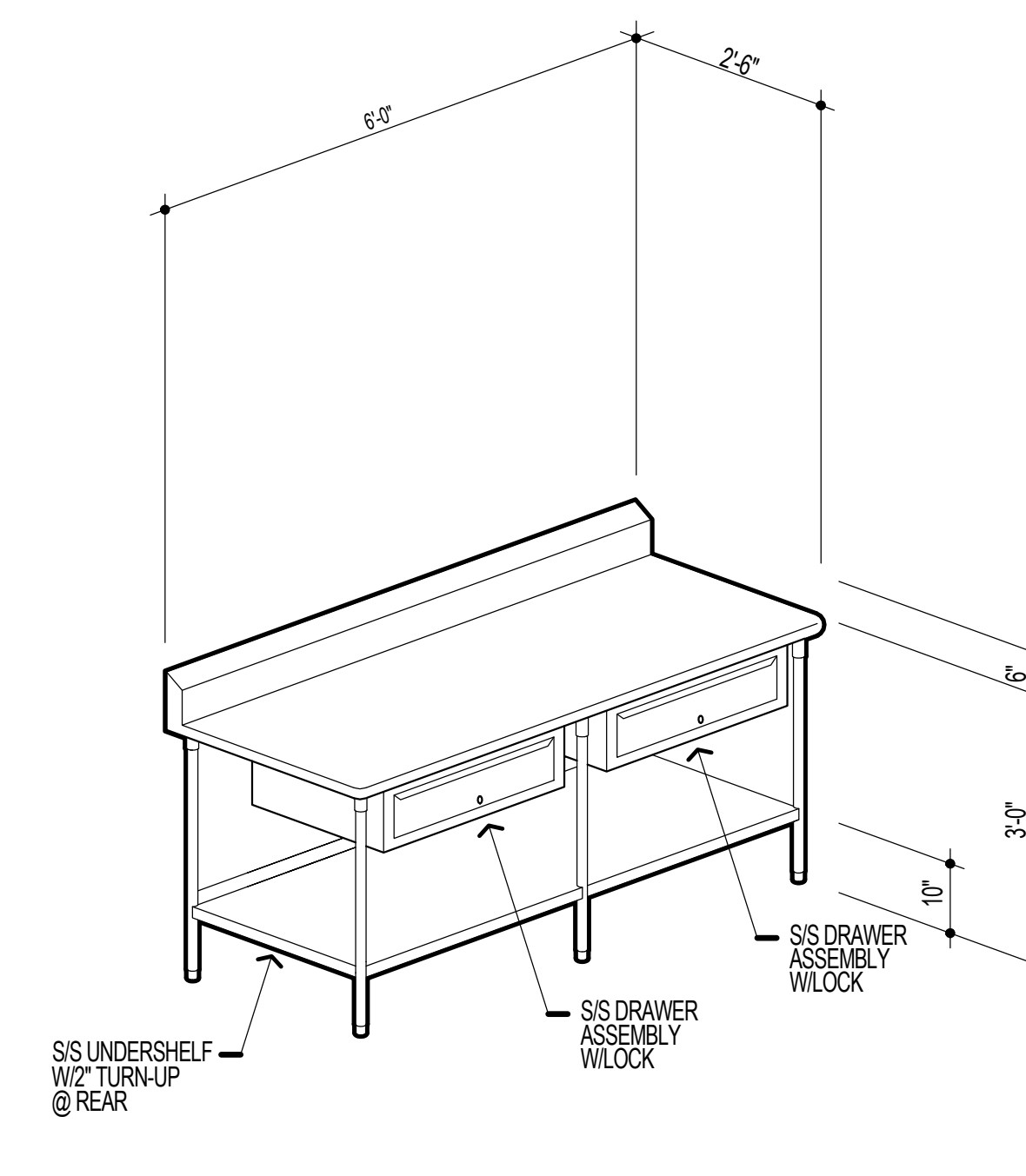

GENERAL HEALTH DEPARTMENT NOTATIONS

1. ALL PIPING, CONDUIT, AND SIMILAR WILL BE EITHER LOCATED INSIDE A WALL, OR INSTALLED WITH A MINIMUM OF 3/4" SPACE FROM THE WALL OR SEALED TO THE WALL.
2. ALL DOORS TO THE OUTSIDE WILL BE SELF-CLOSING AND RODENT-PROOF.
3. A MINIMUM OF FIFTY (50) FOOT CANDLES OF SHIELDED LIGHT WILL BE PROVIDED AT ALL WORK SURFACES, STORAGE AREAS, FOOD PREPARATION AREAS, UTENSIL WASHING AREAS, TOILET ROOMS, LOCKER ROOMS, AND IN THE GARAGE AND RUBBISH STORAGE AREAS.
4. ALL ROOM DOORS WILL BE SELF-CLOSING.
5. ALL RESTROOMS WILL BE EQUIPPED WITH MECHANICAL EXHAUST VENTILATION SIZED AT A MINIMUM RATE OF TWO (2) CUBIC FEET PER MINUTE PER SQUARE FOOT OF FLOOR AREA AND MUST BE DIRECTED TO THE OUTSIDE.
6. ALL FLOOR MOUNTING EQUIPMENT WILL BE PLACED ON NATIONAL SANITATION FOUNDATION (NSF) APPROVED SINK (6) INCH LEGS, OR THE EQUIVALENT, AND PROPERLY SPACED FROM EQUIPMENT OR WALLS TO PROVIDE ACCESS TO ALL HOSE END CASTERS, OR THE EQUIVALENT, OR PROPERLY SEALED TO ALL ADJACENT SURFACES.
7. ALL COUNTER MOUNTED FOOD SERVICE EQUIPMENT WEIGHING IN EXCESS OF EIGHTY (80) POUNDS WILL BE MOUNTED ON NSF APPROVED FOUR (4) INCH HIGH LEGS.
8. ALL EXPOSED RAW WOOD WILL BE PAINTED.
9. ALL ANNUAL OPENINGS IN CONSTRUCTION WILL BE SEALED TO 1/32TH OF AN INCH.
10. ALL AISLES WILL BE A MINIMUM OF THIRTY SIX (36) INCHES WIDE PER NATIONAL FIRE PROTECTION ASSOCIATION 101.
11. THE OUTSIDE STORAGE OF REFUSE WILL BE IN RODENT-PROOF CONTAINERS ON A PAVED SURFACE.
12. ALL SINK INSTALLATIONS WILL BE EQUIPPED WITH HOT AND COLD RUNNING WATER THROUGH A MINIMUM OF TWO (2) INCH DIAMETER OR CONDUIT.
13. ALL PAINTING WILL BE WITH LEAD-FREE, NON-METALLIC ENAMEL PAINT OR A HIGH QUALITY VARNISH.
14. WASTE WATER FROM ALL APPLICABLE FOOD SERVICE EQUIPMENT WILL BE INDIVIDUALLY PLUMBED TO AN OPEN SITE DRAIN OR FLOOR SINK WITH A MINIMUM ONE INCH AIR GAP.

SCALE: 1/4"=1'-0"



THE USE OF SEALANTS IN FOOD SERVICE EQUIPMENT

1. ALL SEALANTS MUST BE LISTED AS APPROVED BY THE NATIONAL SANITATION FOUNDATION (NSF) UNDER 51.
2. SEALANTS SHALL BE USED ONLY ON STRUCTURALLY SOUND JOINTS AND SEAMS.
3. SEALANTS MAY BE USED TO FILL SPACES AND OPENINGS SUCH AS, BUT NOT LIMITED TO, BLIND RIVER HEADS AND SLOT AND PHILLIPS HEAD SCREWS.
4. OPENINGS AROUND SERVICE AND UTILITY LINES SHOULD BE CLOSED INsofar AS PRACTICAL BY:
 - A. COLLARS AND GROMMETS.
 - B. FLEXIBLE FORM GASKETS.
5. SEALANTS MAY BE USED TO SEAL SERVICE AND UTILITY LINES TO WALL AND ADJACENT PIECES OF EQUIPMENT WHERE THE SPACING IS, CLOSED TO LESS THAN 1/8 OF INCH.
6. SEALANTS MAY NOT BE UTILIZED IN FOOD AND SPLASH CONTACT SURFACES, TO FILL OPEN SPACES, OR VOIDS WHICH RESULT DUE TO IMPROPER DESIGN OR FABRICATION, ANY OPENING IN EXCESS OF 1/8" INCH SHALL BE CONSIDERED EXCESSIVE AND MUST BE CLOSED USING PROPER FILL JOINTS.

SCALE: 1/2"=1'-0"

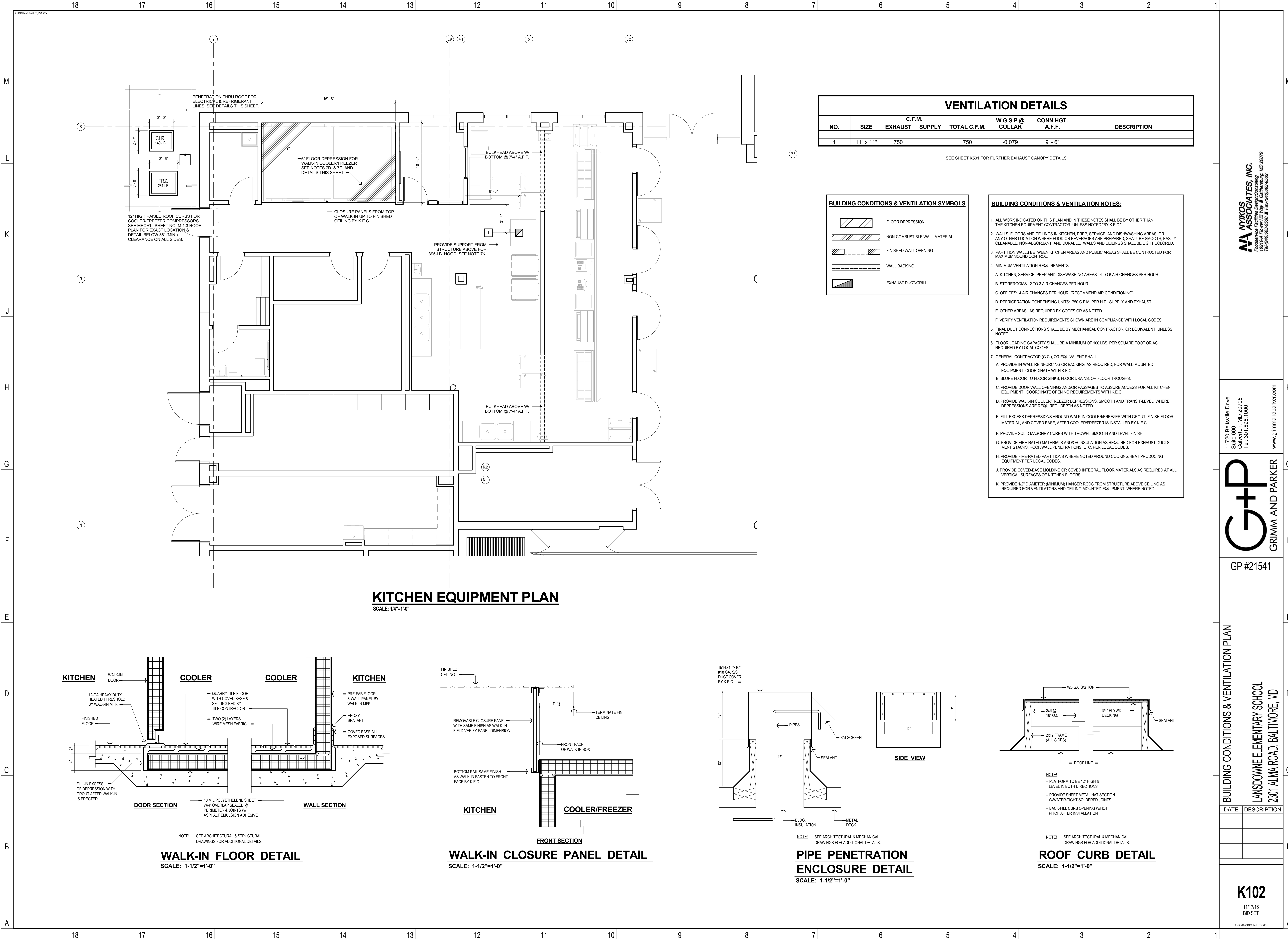

AN NYIKOS ASSOCIATES, INC.
Frederickville Facilities Design/Consulting
18219 A Flower Hill Way ■ Gaithersburg, MD 20879
Tel: (240) 955-9550 ■ Fax: (240) 955-5532

11720 Beltsville Drive
Suite 600
Calverton, MD 20705
Tel: 301.595.1000
www.grimmandparker.com

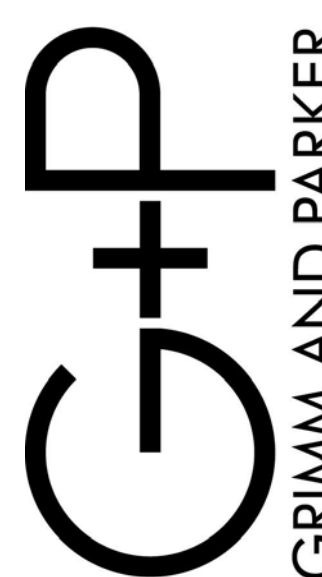

GP #21541

BUILDING CONDITIONS & VENTILATION PLAN
LANSOWNE ELEMENTARY SCHOOL
2301 ALVIA ROAD, BALTIMORE, MD

| DATE | DESCRIPTION |
|------|-------------|
| | |
| | |
| | |
| | |

K102
11/17/16
BID SET

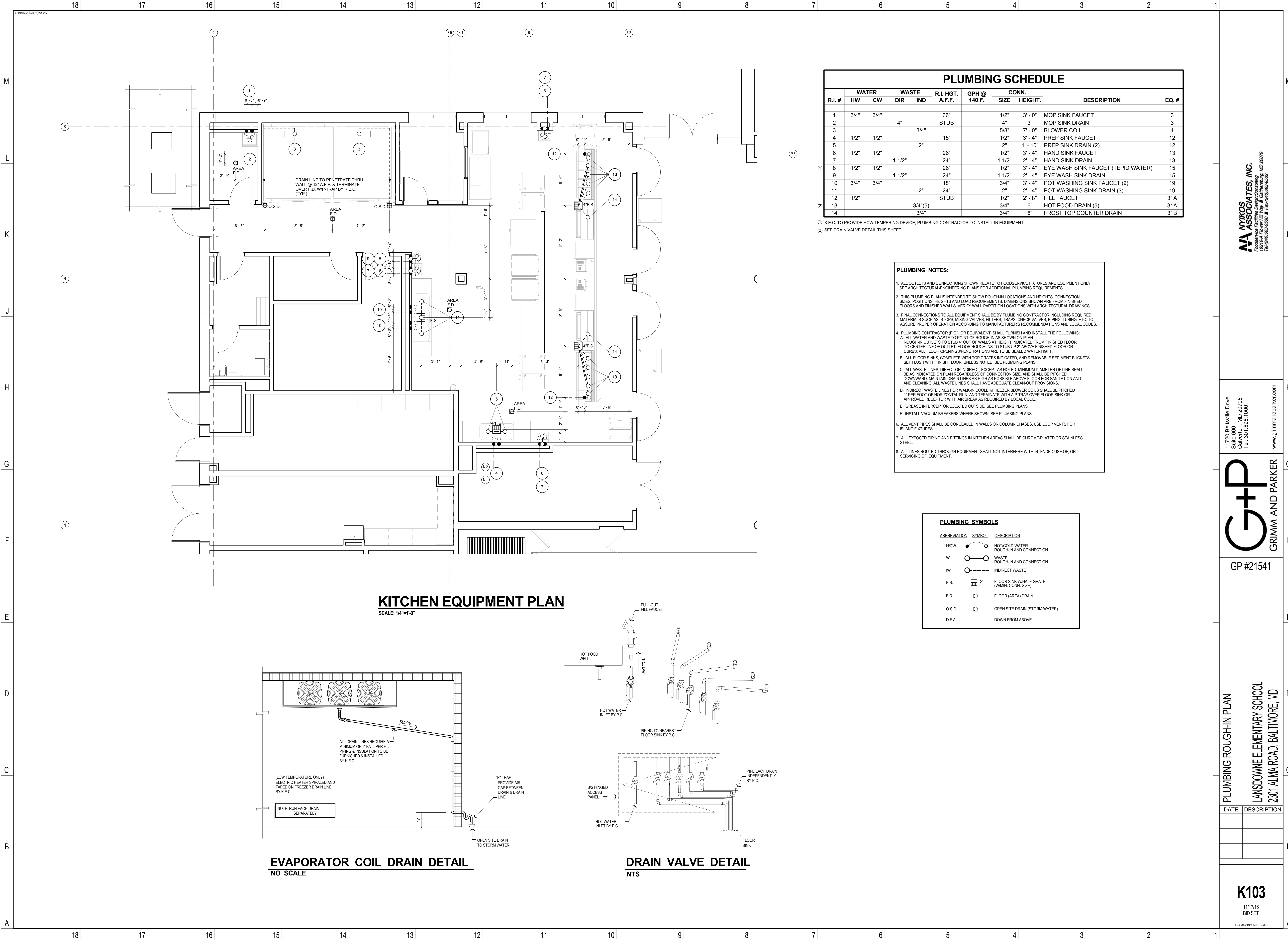

NYKOS ASSOCIATES, INC.
Frederickville Facilities Design/Consulting
18219 A Flower Hill Way ■ Gaithersburg, MD 20879
Tel: (240) 688-9850 ■ Fax: (240) 688-9852

11720 Beltsville Drive
Suite 600
Calverton, MD 20705
Tel: 301.595.1000
www.grimmandparker.com









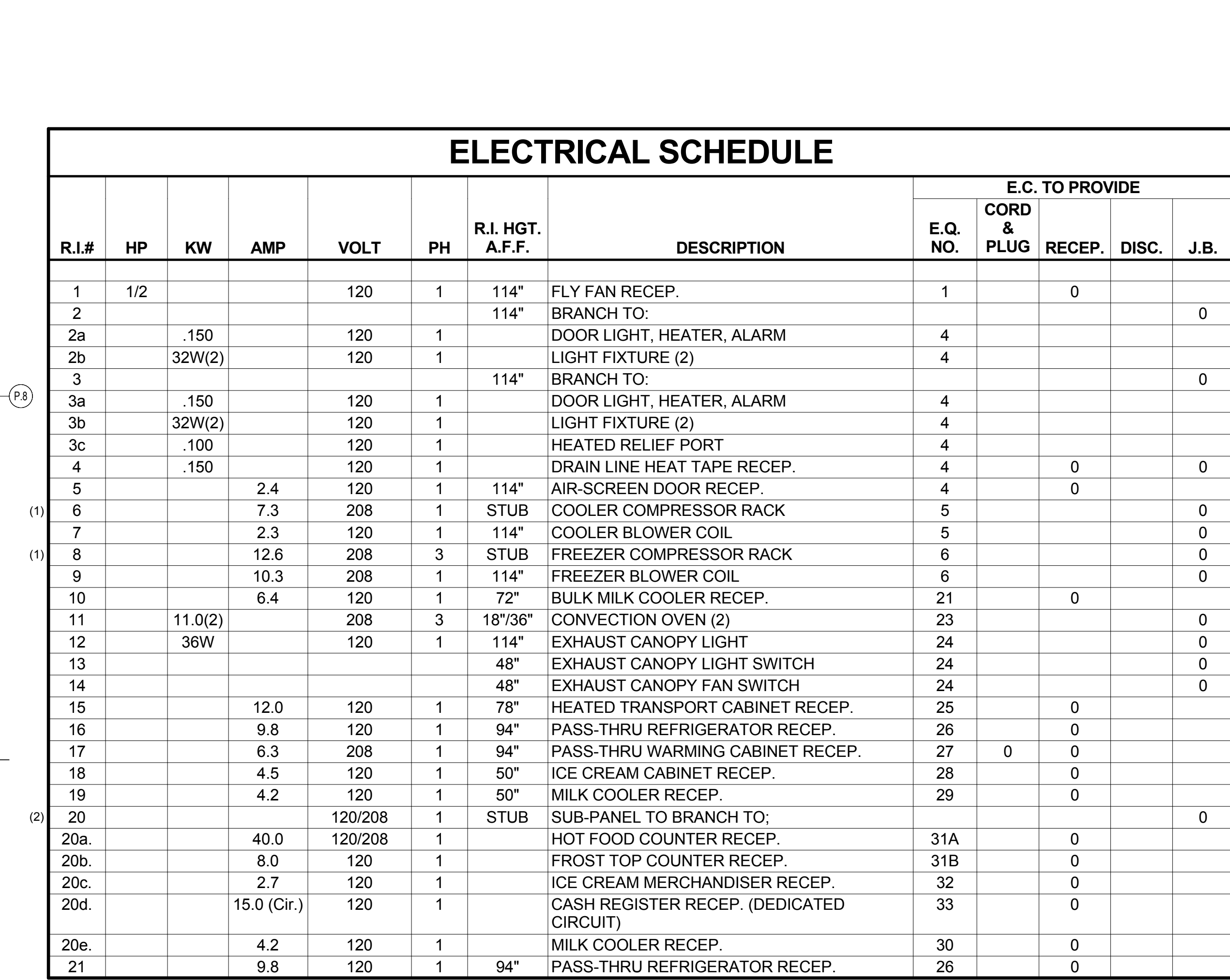

GP #21541

PLUMBING ROUGH-IN PLAN
LANSOWNE ELEMENTARY SCHOOL
2301 ALVIA ROAD, BALTIMORE, MD

| DATE | DESCRIPTION |
|------|-------------|
| | |
| | |
| | |

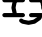
K103
11/17/16
BID SET

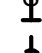
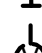
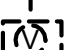

| <u>ELECTRICAL SYMBOLS</u> | |
|---|--|
|  | JUNCTION BOX W/IFINAL CONN. TO EQUIPMENT |
|  | JUNCTION BOX (INSTALLED IN EQUIPMENT BY K.E.C. OR MFR.) |
|  | DUPLEX CONVENIENCE OUTLET |
|  | DUPLEX CONVENIENCE OUTLET (INSTALLED IN EQUIP. BY K.E.C. OR MFR.) |
|  | POWER OUTLET, 1 PHASE |
|  | CONDUIT STUB W/IFINAL CONN. TO EQUIPMENT |
|  | SWITCH |
|  | SWITCH (INSTALLED IN EQUIP. BY K.E.C. OR MFR.) |
|  | VAPOR PROOF LIGHT FIXTURE |
|  | L.E.D. LIGHT FIXTURE |
|  | DOWN FROM ABOVE |

AN NYKOS ASSOCIATES, INC.
Foodservice Facilities Design/Consulting
18219-A Flower Hill Way ■ Gaithersburg, MD 20879
Tel: (240) 683-9530 ■ Fax: (240) 683-9532

www.grimmandparker.com

G+p
GRIMM AND PARKER

ELECTRICAL ROUGH-IN PLAN
LANDSDOWNE ELEMENTARY SCHOOL
2301 ALMA ROAD, BALTIMORE, MD

| DATE | DESCRIPTION |
|------|-------------|
|------|-------------|

11/17/16
BID SET

© GRIMM AND PARKER, R.C. 2011

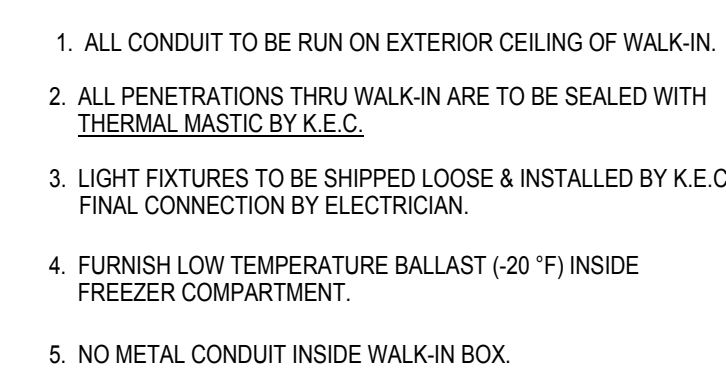

WALK-IN LIGHT INSTALLATION DETAIL

SCALE: NONE

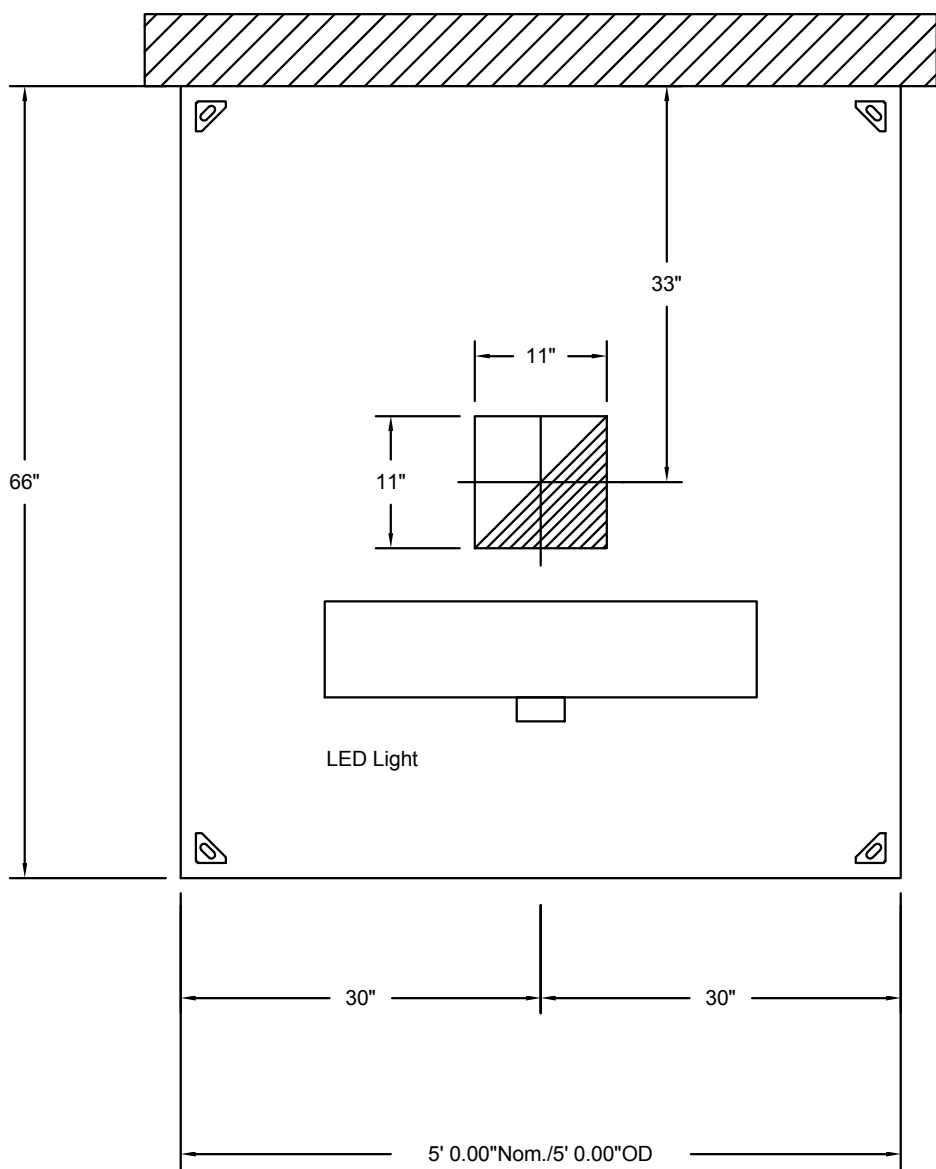

PLAN VIEW - Hood #1
5' 0.00" LONG 6630VHB

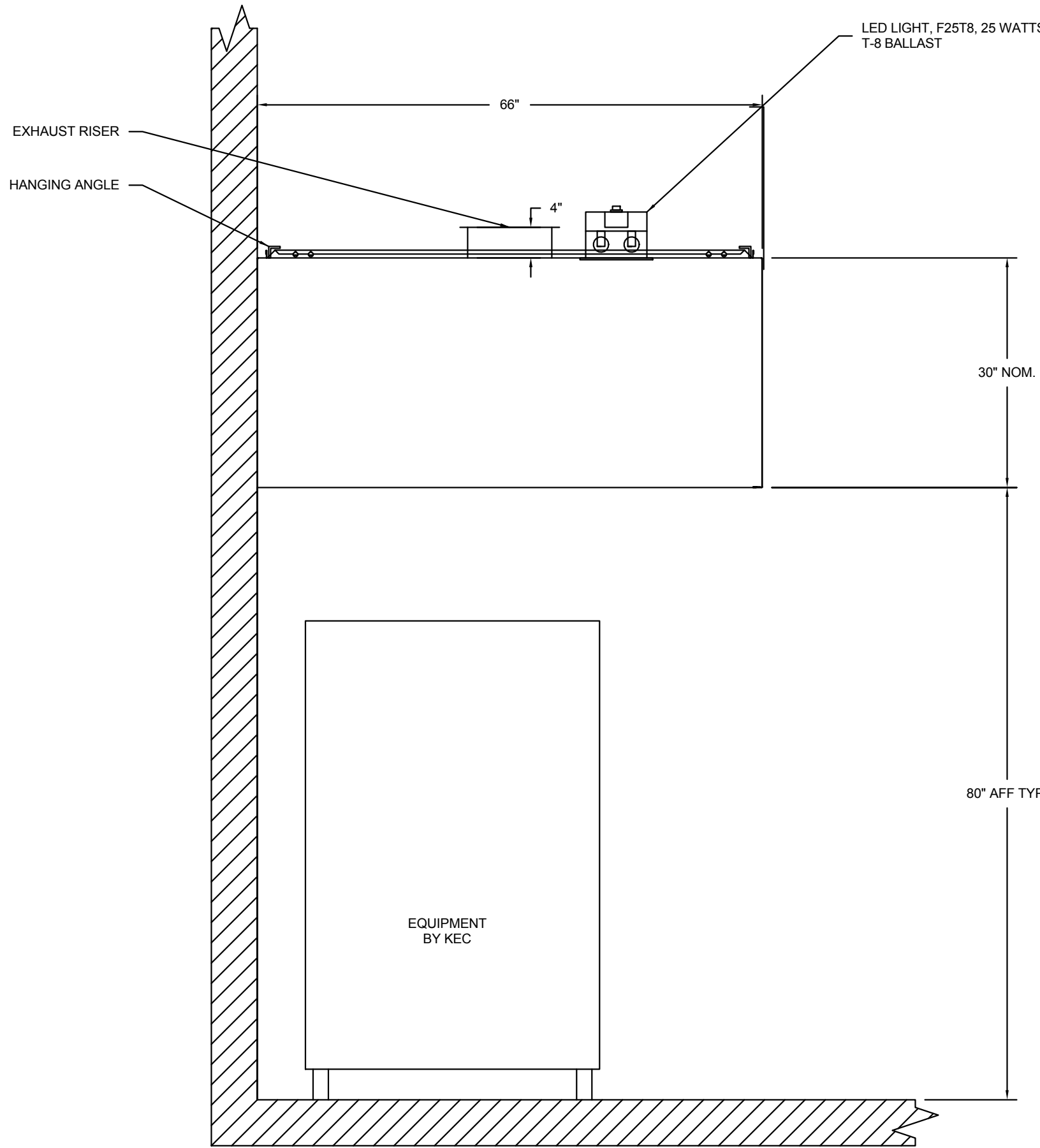

SECTION VIEW - MODEL 6630VHB

HOOD INFORMATION

| HOOD NO. | MODEL | LENGTH | MAX. COOKING TEMP. | TOTAL EXH. CFM | EXHAUST PLENUM RISE(S) | | | | | HOOD CONSTRUCTION | HOOD CONFIG. | | SWITCHES | |
|----------|----------|----------|--------------------|----------------|------------------------|-------|------|-----|---------|-------------------|--------------|-------|------------------|----------|
| | | | | | WIDTH | LENG. | DIA. | CFM | S.P. | | END TO END | ROW | QUANTITY | LOCATION |
| 1 | 6630 VHB | 5' 0.00" | 700 Deg. | 750 | 11" | 11" | | 750 | -0.079" | 304 SS 100% | ALONE | ALONE | 1 FAN 1 LIGHT | |

HOOD INFORMATION

| HOOD NO. | FILTER(S) | | | | LIGHT(S) | | | UTILITY CABINET(S) | | | | | |
|----------|-----------|------|--------|--------|----------|--------------|------------|--------------------|-------------|------|--------------------|-------------------|--------------------|
| | TYPE | QTY. | HEIGHT | LENGTH | QTY. | TYPE | WIRE GUARD | LOCATION | FIRE SYSTEM | SIZE | ELECTRICAL MODEL # | SWITCHES QUANTITY | FIRE SYSTEM PIPING |
| 1 | | | | | 1 | L.E.D. Light | NO | | | | | | NO |

HOOD ACCESSORIES

| HOOD NO. | ACCESSORIES |
|----------|---|
| 1 | FIELD WRAPPER 18.00" High Front, Left, Right, See detail below. |
| | BACKSPLASH 80.00" High X 60.00" Long 304 SS |

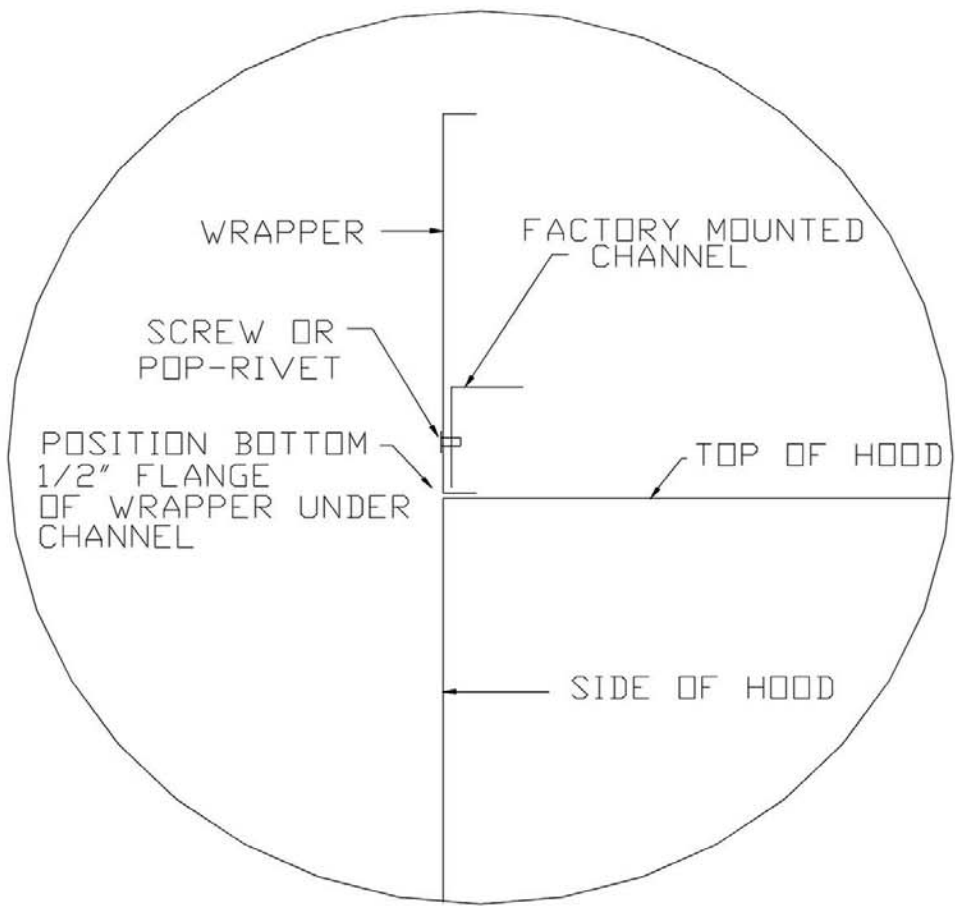

HOOD AND LIGHT SWITCHES
WALLMOUNTED BY EC

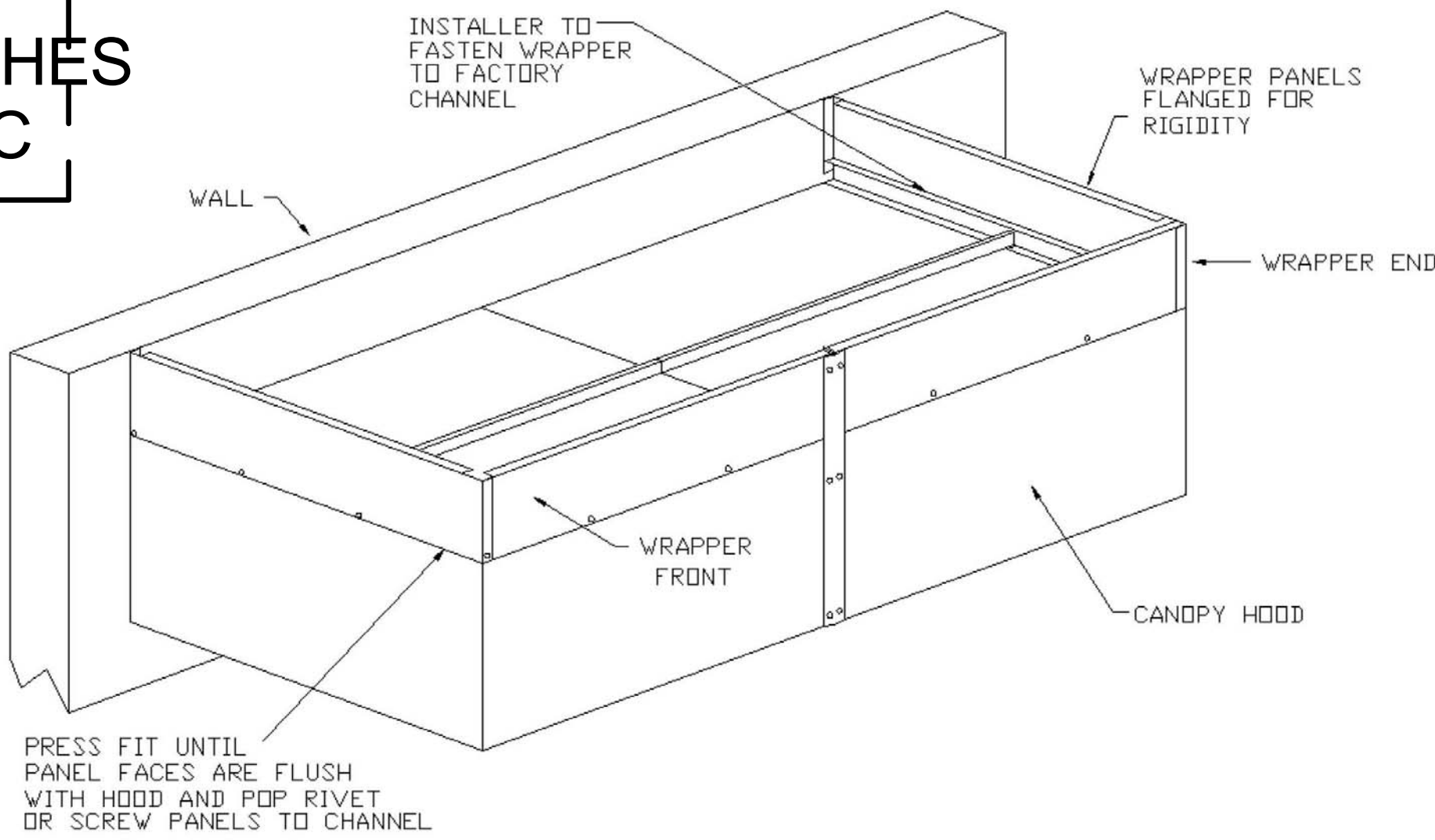

CLOSURE PANEL DETAILS

LED LIGHTS BY KEC.
BULBS MUST BE RATED FOR
5000K COLOR TEMP.

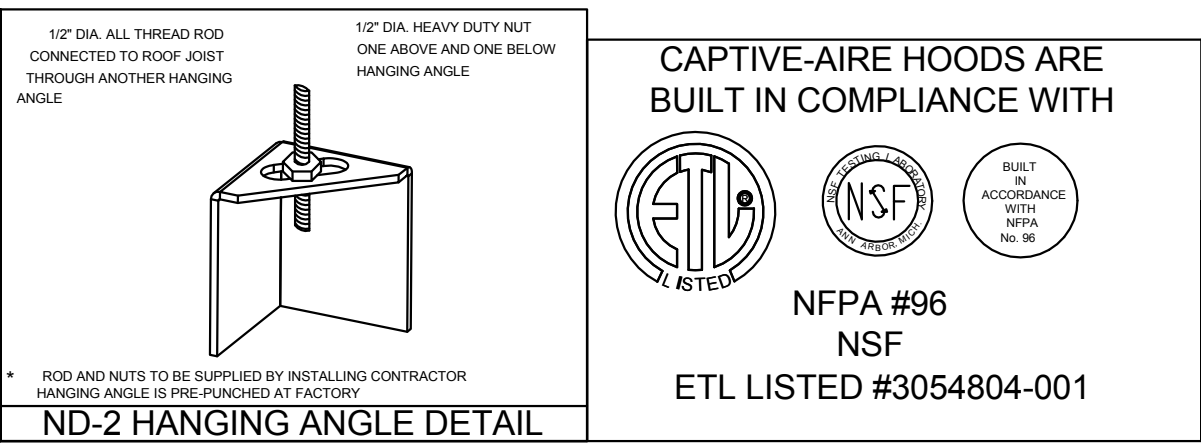

NYIKOS ASSOCIATES, INC.
Frederickville Facilities Design/Consulting
18219 A Flower Hill Way ■ Gaithersburg, MD 20879
Tel: (240) 959-9830 ■ Fax: (240) 959-9832

11720 Beltsville Drive
Suite 600
Calverton, MD 20705
Tel: 301.595.1000
www.grimmandparker.com

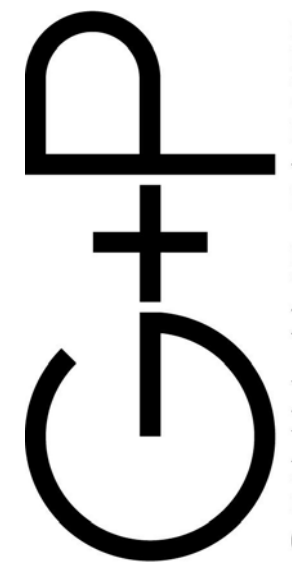

GP #21541

EXHAUST CANOPY DETAILS
LANSOWNE ELEMENTARY SCHOOL
2301 ALMA ROAD, BALTIMORE, MD

| DATE | DESCRIPTION |
|------|-------------|
| | |
| | |
| | |
| | |

K501
11/17/16
BID SET